



## 14 Seavert Close

Carlton Colville, Lowestoft, NR33 8TX

Asking Price £350,000



## 14 Seavert Close

Carlton Colville, Lowestoft, NR33 8TX

Aldreds are delighted to offer this four bedroom executive detached bungalow with a double garage situated in this very desirable cul-de-sac within Carlton Colville. This outstanding property offers versatile spacious accommodation including a wide 'T' shaped entrance hall, spacious lounge leading into a conservatory, kitchen/breakfast room, separate utility room, family bathroom and upto four bedrooms with bedroom two having an ensuite shower. Outside to the front there is a large driveway providing ample off road parking leading to a double brick built garage. To the rear there is a sizeable lawned garden with very private side and rear aspects. Benefits also include gas fired central heating fired by a modern energy efficient gas boiler and all windows and doors are timber effect uPVC sealed unit double glazed. The property is situated within walking distance of local amenities, major shops and supermarkets and Pakefield beach is also within easy reach. Large executive style bungalows in this desirable cul-de-sac rarely become for sale and an early viewing is strongly recommended. NO ONWARD CHAIN.

### Wide 'T' Shaped Entrance Hall

Fitted carpet, coved ceiling, radiator, uPVC entrance door, loft access, power points, full length airing cupboard.

### Cloakroom

Ceramic tiled flooring, cloakroom suite comprising of a low level WC, vanity sink unit, uPVC window, tiled splashbacks.

### Lounge

12'0" x 16'7" (3.67 x 5.06)

Fitted carpet, coved ceiling, radiator, power points, tv point, modern fireplace with timber surround and marble effect hearth and inset with living flame electric fire, double sliding patio doors leading to:-

### Conservatory

8'2" x 9'8" (2.5 x 2.95)

Vinyl flooring, polycarbonate roof, large aspect sealed unit double glazed windows, power points.

### Dining Room/Bedroom 4

9'6" x 8'6" (2.9 x 2.61)

Fitted carpet, power points, radiator, uPVC window.





### Kitchen/Breakfast Room

9'9" x 12'10" (2.98 x 3.92)

Tile effect vinyl flooring, a range of modern fitted kitchen units, extended work surfaces, double stainless steel sink with single drainer, stainless steel extractor cooker hood, tiled splashbacks, recess for white goods including plumbing for a dishwasher, area for a breakfast bar, tv point, power points, spotlighting, large aspect uPVC window.

### Utility Room

Tile effect vinyl flooring, a range of modern fitted base and wall units, extended work surface, tiled splashbacks, recess for white goods, plumbing for a washing machine, condensing wall mounted energy efficient boiler, uPVC door leading out to the garden, uPVC window, power points.

### Bedroom 1

12'1" x 12'0" (3.7 x 3.68)

Fitted carpet, uPVC window, radiator, power points.

### Bedroom 2

10'3" x 11'4" (3.14 x 3.47)

Fitted carpet, uPVC bay window, radiator, power points, ensuite fully tiled shower cubicle.

### Bedroom 3

11'3" x 9'2" (3.44 x 2.81)

Fitted carpet, uPVC window, radiator, power points.

### Family Bathroom

Ceramic tiled flooring, white bathroom suite comprising of a shower set over a panel bath, pedestal sink, low level WC, fully tiled walls, heated towel rail, uPVC window.

### Outside

To the front of the property there is a wide driveway providing ample off road parking for a variety of cars or leisure vehicles leading to a detached double pitched roof garage with up & over doors, power & lighting. Outside to the rear there is a sizeable lawned garden with patio seating area with a further side garden with brickweave pathways, a range of flower & shrub borders, all enclosed by high fencing and brick walls with a very private rear and side aspect.



Floor Plan

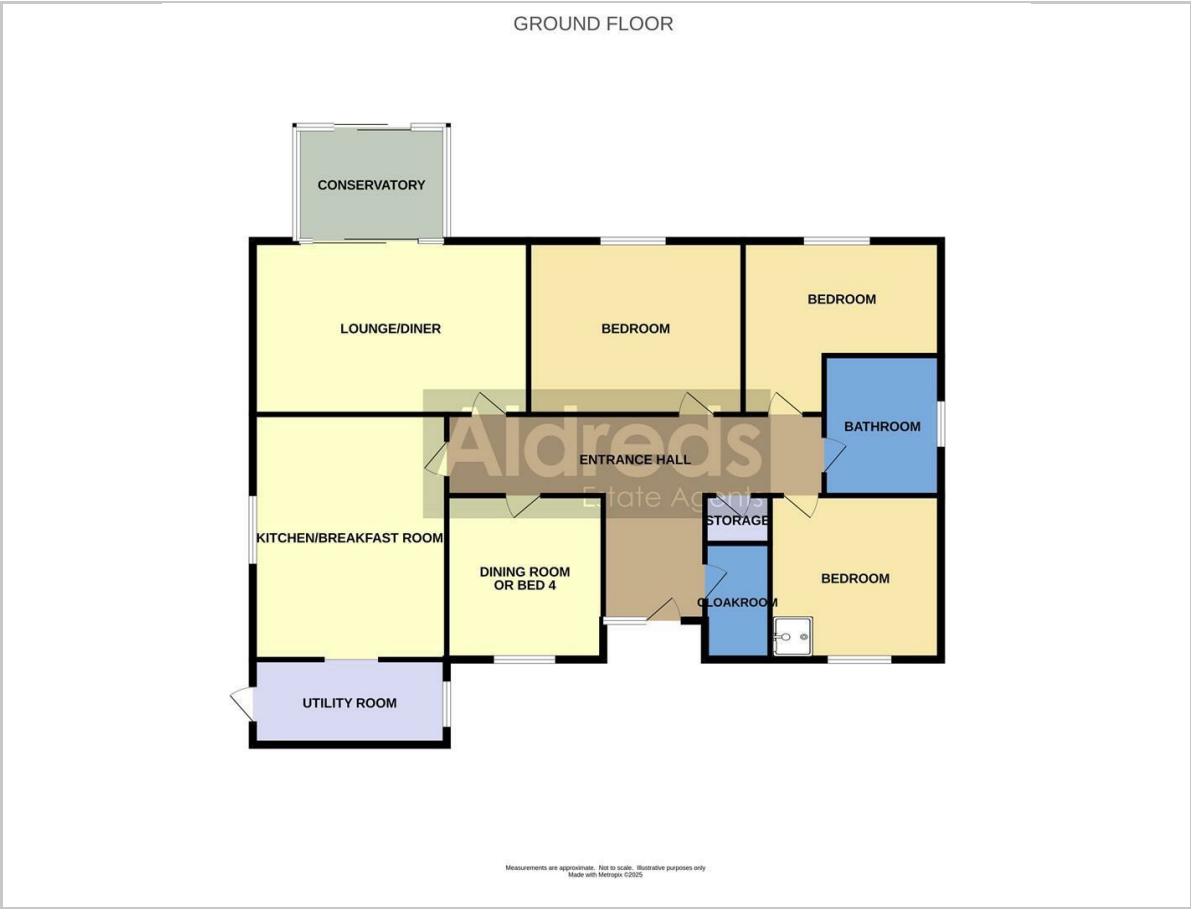

Viewing

Please contact our Aldreds Lowestoft Office on 01502 565432 if you wish to arrange a viewing appointment for this property or require further information.

**Disclaimer**  
These particulars are issued on an understanding that all negotiations shall be conducted through Messrs. Aldreds. Please note: Messrs. Aldreds for themselves and for the vendors or lessors of this property whose agents they are given notice that: 1. Particulars are set out as a general outline only for guidance of intending purchasers or lessees, and do not constitute nor constitute part of, an offer or contract. 2. All descriptions, dimensions, references to condition and necessary permissions for use and occupation, and other details are given without responsibility and any intending purchasers or tenants should not rely on them as statements or representations of fact but must satisfy themselves by inspection or otherwise as to the correctness of each of them. 3. No person in the employment of Messrs. Aldreds has any authority to make or give any representation or warranty whatever in relation to this property. 4. If you are proposing to visit the property and are travelling some distance please check with Aldreds on the issue of availability prior to travelling. 5. Aldreds Property Consultants and associated services may offer additional services to the prospective purchaser for which they will be entitled to receive a commission. Aldreds are pleased to be working with Mortgage Advice Bureau. They're an award-winning mortgage broker with over 1,400 advisers across the UK, and have access to over 12,000 mortgage products from over 90 lenders. Aldreds Estate Agents Ltd receive a commission of £200 on each completed case. Your home may be repossessed if you do not keep up repayments on your mortgage. There may be a fee for mortgage advice. The actual amount you pay will depend upon your circumstances. The fee is up to 1%, but a typical fee is 0.3% of the amount borrowed. Mortgage Advice Bureau is a trading name of Mortgage Seeker Limited which is an appointed representative of Mortgage Advice Bureau Limited and Mortgage Advice Bureau (Derby) Limited which are authorised and regulated by the Financial Conduct Authority. Mortgage Seeker Limited Registered Office: Lovewell Blake, Sixty Six North Quay, Great Yarmouth, Norfolk, NR30 1HE. Registered in England Number: 03721415. 6. Potential purchasers should check with their providers that the broadband and mobile phone coverage they would require is available.

Area Map

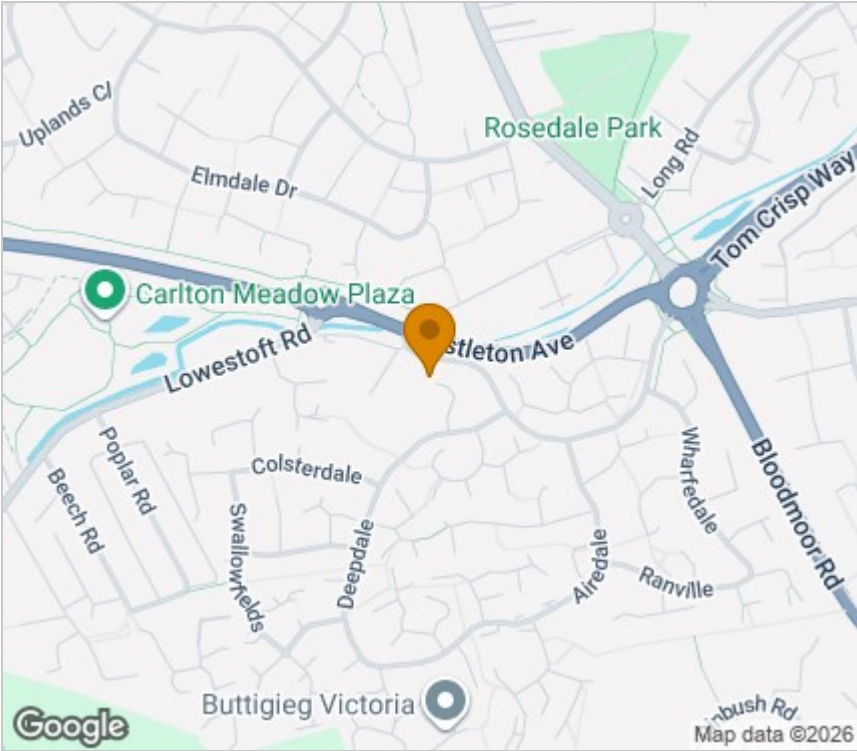

Energy Efficiency Graph

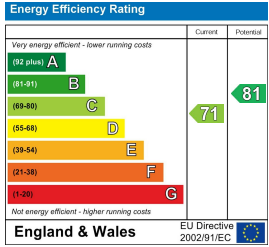

143 London Road North, Lowestoft, Suffolk, NR32 1NE  
Tel: 01502 565432 Email: [lowestoft@aldreds.co.uk](mailto:lowestoft@aldreds.co.uk) <https://www.aldreds.co.uk/>  
Registered in England Reg. No. 08945751 Registered Office: 17 Hall Quay, Great Yarmouth, Norfolk NR30 1HJ  
Directors: Mark Duffield B.S.c. FRICS. Dan Crawley MNAEA Paul Lambert MNAEA